



7, Chapel Court Gellings Avenue, Port St. Mary, Isle of Man, IM9 5BG
Asking Price £235,000



- Modern first floor apartment in village centre
- Two double bedrooms including en-suite & additional family bathroom
- Sea views from living space and bedrooms
- Secure underground parking space included, with lift to all floors
- Spacious open plan living and kitchen area
- Turn-key sale with furniture and no chain



7, Chapel Court Gellings Avenue, Port St. Mary, Isle of Man, IM9 5BG

This well presented, modern purpose-built first floor apartment is positioned in the heart of the village, just a short walk from local shops, cafés and everyday amenities, while also enjoying pleasant sea views. The accommodation is generous and well laid out, with a bright open plan living, dining and kitchen space forming the hub of the home. The kitchen is finished in a contemporary style with ample storage and workspace, making it ideal for both daily living and entertaining.

There are two well proportioned double bedrooms, with the principal bedroom benefiting from sea views and a modern en-suite bathroom. A separate main bathroom serves the second bedroom and guests and is finished to a similarly high standard. Additional practical features include a useful internal storage cupboard with space for laundry appliances and an entry phone system.

The apartment further benefits from a designated parking space within a secure underground car park, together with lift access serving all floors. The property can be sold on a turn-key basis, with all furniture included, allowing a buyer to move straight in or begin letting immediately. Offered for sale with no onward chain, this is an excellent opportunity to acquire a low maintenance home in a highly convenient and sought-after village location.













7, Chapel Court Gellings Avenue, Port St. Mary, Isle of Man, IM9 5BG



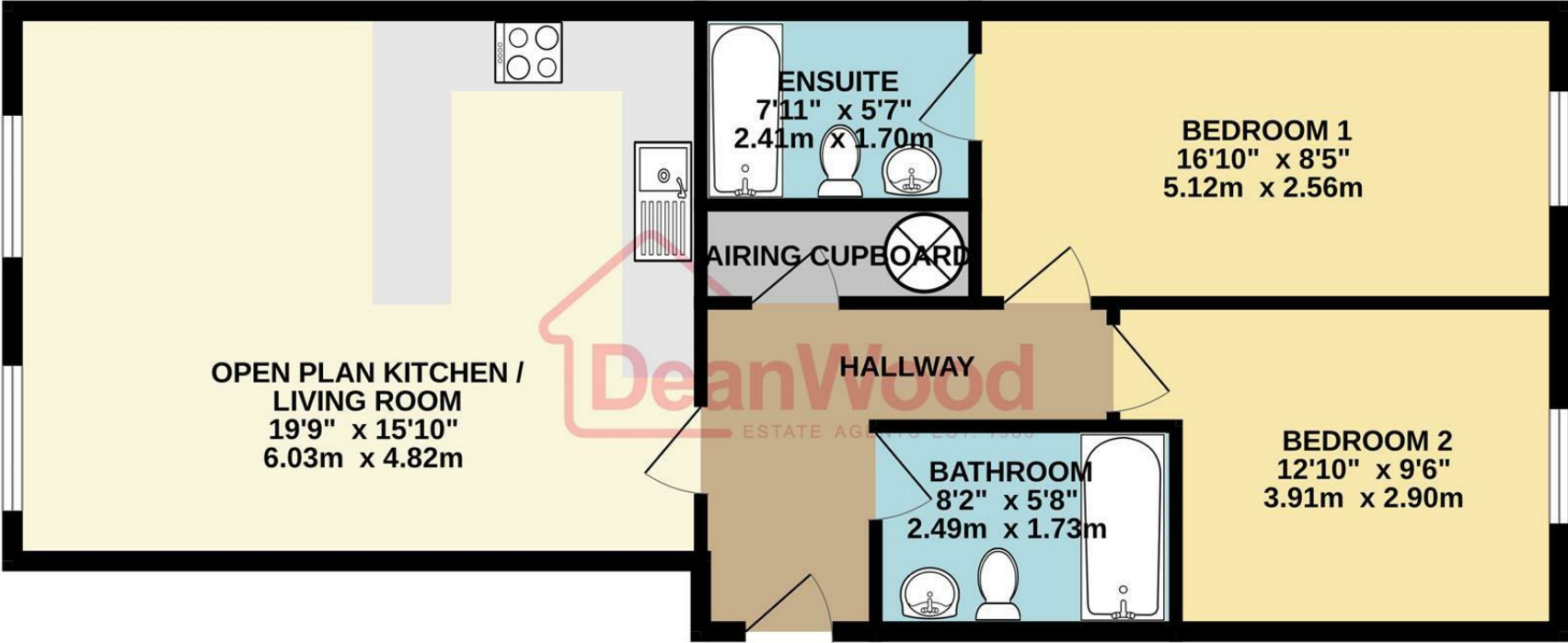

FIRST FLOOR
754 sq.ft. (70.0 sq.m.) approx.

TOTAL FLOOR AREA : 754 sq.ft. (70.0 sq.m.) approx.
Not to scale-for identification purposes only
Made with Metropix ©2026



DOUGLAS
37 VICTORIA STREET
DOUGLAS
ISLE OF MAN IM1 2LF
T 01624 620606
F 01624 677363
E info@deanwood.co.im

CASTLETOWN
COMPTON HOUSE
9 CASTLE STREET CASTLETOWN
ISLE OF MAN IM9 1LF
T 01624 825995
F 01624 825996
E castletown@deanwood.co.im

RAMSEY
LEZAYRE HOUSE
87 PARLIAMENT STREET
RAMSEY ISLE OF MAN IM8 1AQ
T 01624 816111
F 01624 816588
E ramsey@deanwood.co.im

These particulars are for information purposes only. They do not constitute or form any contract nor should any statement contained herein be relied upon as a representation of fact. Neither the vendor nor DeanWood Agencies Limited ('the firm'), nor any officer or employee of the firm accept liability or responsibility for any statement contained herein. The vendor does not by these particulars, nor does the firm, nor does any officer or any employee of the firm have any authority to make or give any representation or warranty whatsoever as regards the property or otherwise. It is the sole responsibility of any person interested in the property described in these particulars to make all proper enquiries and searches to verify the description of the property and all other particulars herein.

FOR MORE PROPERTIES VISIT OUR WEBSITE @ **deanwood.im**